

## MD-S650 INTELLIGENT DIGITAL PRESSURE SWITCH

### TECHNICAL CHARACTERISTICS:

- ✓ 4 digit LED, Acc. > 0.5%FS
- ✓ Multiple pressure units, one key to zero clearing
- ✓ Equipped with mounting bracket and fuse
- ✓ Double relay output signal, each group with normally open and closed, independent hysteresis setting



MD-S650 is a intelligent digital pressure switch setting pressure measurement, pressure display, control in one professional unit. It uses imported pressure sensor as its sensitive element. So it has followed features: high precision, long-term stability, good medium compatibility.

We pay more attention to the circuit stability of MD-S650 because of considering the operation environments with strong anti-interference capacity, electronic protection, surge protection. And the fuse can be changed by customer.

The shell uses PA6 engineering plastics and the connector uses 304SS. The product is equipped with mounting bracket to meet different requirements of different operation situations. Else, MD-S650 is easy to install and operate for customer without operation instruction.

### APPLICATION:

- ◇ Machine Automation
- ◇ Engineering Machinery
- ◇ Medical Equipment
- ◇ Pump/compressor
- ◇ Source and water treatment system
- ◇ Agricultural Machinery
- ◇ Testing Jig
- ◇ Hydraumatic and pneumatic system

### SPECIFICATION:

Range	-100Kpa~0...10KPa...50Kpa ...100KPa 0~1Bar...2...6...10...16...25...50...100...250...400...600Bar
Overload Capacity	≤10Mpa 200% ; >10Mpa 150% ;
Alarm Setting	Every point can be set within the range
Alarm Method	Two groups relays ( NO/NC )
Acc.	± 0.5%FS ± 0.25%FS (selectable)
Long-term Stability	Typical: ± 0.2%FS/year
Load Capacity	220VAC 5A ;24VDC 5A
Supply	24VDC 220VAC 380VAC(selectable)
Operation Temperature	-40 ~ 85°C
Compensation Temperature	-20 ~ 60°C
Electrical Protection	Surge protection, electronic protection, anti-interference capacity
Fuse	250V1A 24V1A
Measurement Medium	Liquid, gas compatible with 316SS
Connector	M20*1.5、NPT1/4、G1/4 ( others are customized )
Connector Material	304SS
Sensor Mebrane	316LSS
Shell	ABS Engineering plastics
Standard Accessory	Multifunction mounting bracket



SIZE:

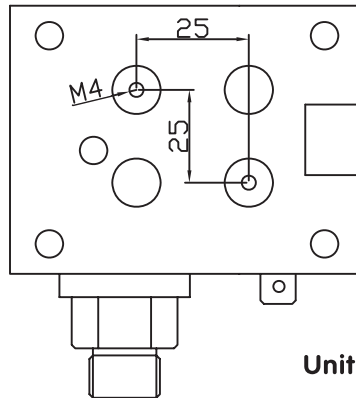
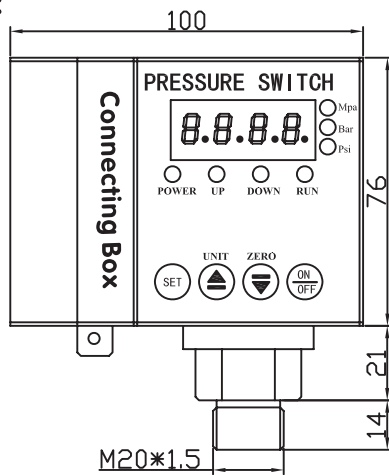

Unit:mm

Connecting Description:

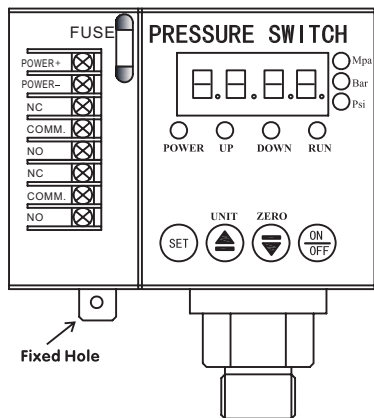

Mounting Bracket Size:

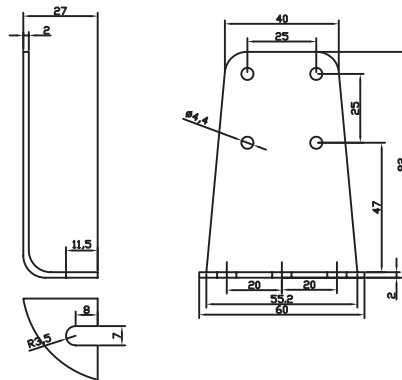

SELECT GUIDE:

MD — S650 — 16b — 1 — J — P2 — M1 — D — T1 — L

Range:

- X b(0-Xbar)
- X M(0-X Mpa)
- X P(0-X PSI)

Acc.:

- 1 (0.5% FS) 2 (0.25% FS)

Output:

- J (Relay output) E (Others)

Supply:

- P2(24VDC)
- P4(220VAC)
- P5(380VAC)

Addition:  
L Display

Medium Temperature:

- T1 (-20~+80°C)
- T3 (0~+150°C)
- T4 (0~+200°C)

Electrical Connecting:

- D (Socket Type)

Screw Connector:

- M1 (M20\*1.5) M2 (G1/4)
- M3 (G1/2) M7 (Customized)