

MD-G602 SERIES PRINTER PRESSURE SENSOR

TECHNICAL CHARACTERISTICS:

- ✓ Laser welding structure, resistant to repeated high frequency pressure shock
- ✓ Resistant to methyl ethyl ketones
- ✓ Fast response speed and good circuit stability
- ✓ Designed for the characteristics of the printer



MD-G602 series printer pressure sensor adopts laser welding integrated structure, resistant to corrosion by methyl ethyl ketones. The circuit part adopts a fully intelligent processing chip, which makes the sensor have high reliability, excellent consistency and mass production capacity

This pressure sensor is with compact size and convenient installation. We can provide OEM service for printer manufacturers, customized connection, output signal and laser marking

APPLICATIONS:

- ◇ Inkjet printer

TECHNICAL PARAMETERS:

Range	0~5...10bar
Overload pressure	200%
Package Structure	Laser welding integration
Accuracy	0.5%FS
Zero error	1%FS
Response time	≤ 2ms
Long-term stability	Typical: ± 0.3%FS/year
Zero temperature drift	Typical: ± 0.03%FS/°C, Maximum: ± 0.05%FS/°C
Sensitivity temperature drift	Typical: ± 0.03%FS/°C, Maximum: ± 0.05%FS/°C
Power supply	5V
Output	0.5~4.5V/0~5V(customized)
Operation temperature	-20~80°C
Compensation temperature	0~60°C
Storage temperature	-40~100°C
Electrical protection	Anti-reverse protection, anti-frequency interference design
IP rating	IP 66
Measurement medium	ink
Connection	M10*1, G1/4, NPT1/8 (customized)
Shell material	SS 304



DIMENSION:

UNIT:mm

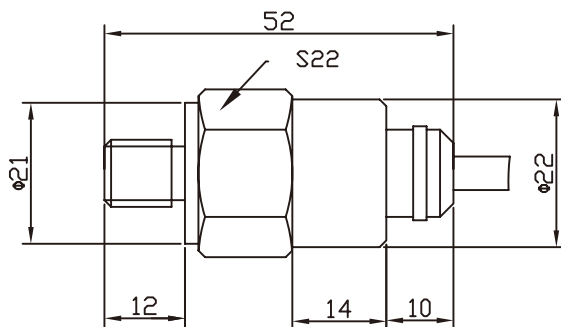
OUTLET DEFINITION:

Voltage output 0-5V 0.5-4.5V	Power supply+	Red
	Common ground	Black
	Output+	Green

SELECTION GUIDE:
MD - G602 - 5b - 1 - V3 - P1 - M10 - B - T1
Model:

 G602
(Inkjet printer)

Range:

 X b(0-X bar)
X M(0-X MPa)

Accuracy:

1(1%FS)

Output:

V2(0-5V) V3(0.5-4.5V)

Measurement
temperature:

T1 (-20~+80℃)

Electric connection:

B (Straight out)

Screw thread:

 G18 (G1/8)
M9(Customized)

Power supply:

P1(5V) P6(12V)

M10(M10*1)

